



160RE

UNOKLIMA

XT160

DK: Brugsvejledning for fjernbetjening, side 2

UK: Instructions for use - remote control, page 3

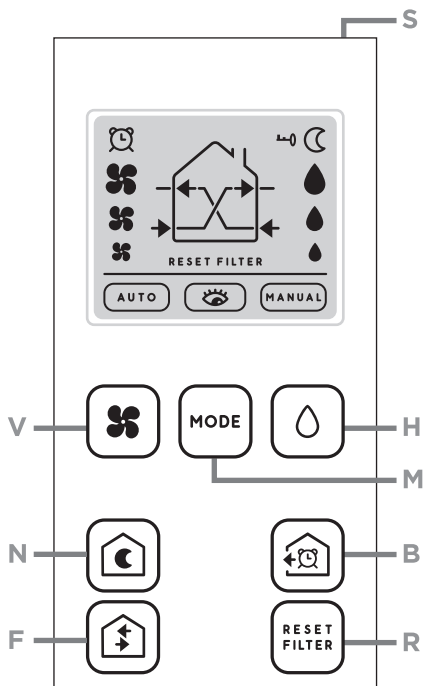

PRODUKT OPSTART

For at bruge fjernbetjeningen, skal der indsættes to batterier af typen CR2032

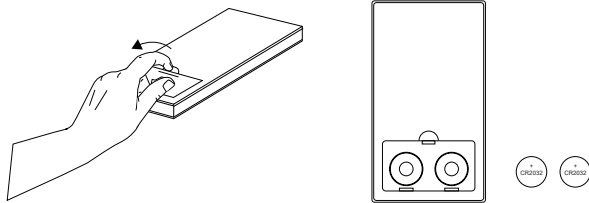

UDSKIFTNING AF BATTERI

Hvis produktet ikke længere reagerer på kommandoer fra fjernbetjeningen, eller hvis skærmen er slukket, skal batterierne udskiftes. Det anbefales at bortskaffe batterier i henhold til lokale bestemmelser. Batterier må ikke bortskaffes i dagrenovationen.

LISTE OVER FUNKTIONSKNAPPER:

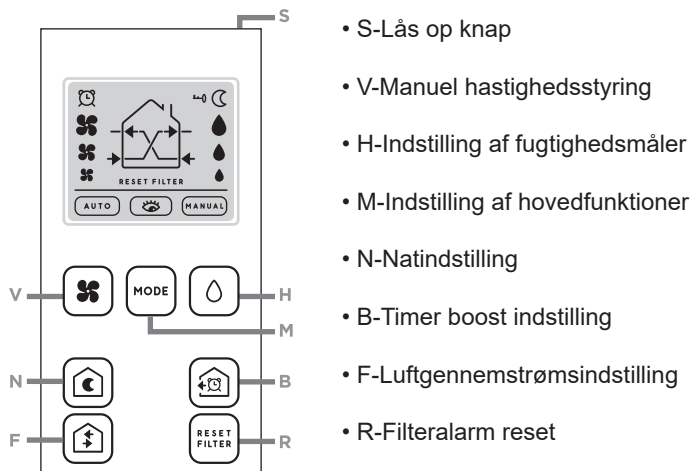

BRUGSANVISNING

Tryk på den relevante knap for at vælge en funktion.

For at låse knapperne op trykkes på knappen (S) på den øverste del af fjernbetjeningen.

Detaljeret forklaring af alle betjeningstilstande findes i manualen:

Installation – Drift - Vedligeholdelse

VÆGMONTERET HOLDER TIL FJERNBETJENING

Fastgør fjernbetjeningsholderen til væggen som vist på billedet nedenfor.

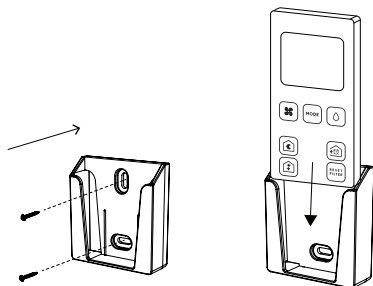

PRODUCT INIALIZATION

To start using the remote control insert two batteries type CR2032

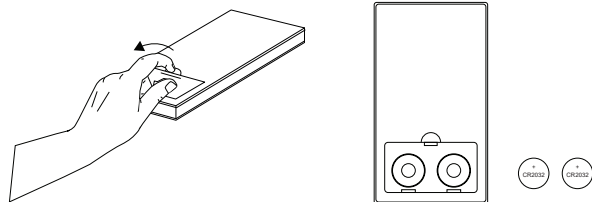

BATTERY REPLACEMENT

If the product no longer responds to the commands sent by the remote control or the display is turned OFF replace the batteries. It is recommended to dispose of batteries in the dedicated collection boxes or according to local laws.

BUTTONS FUNCTION LIST:

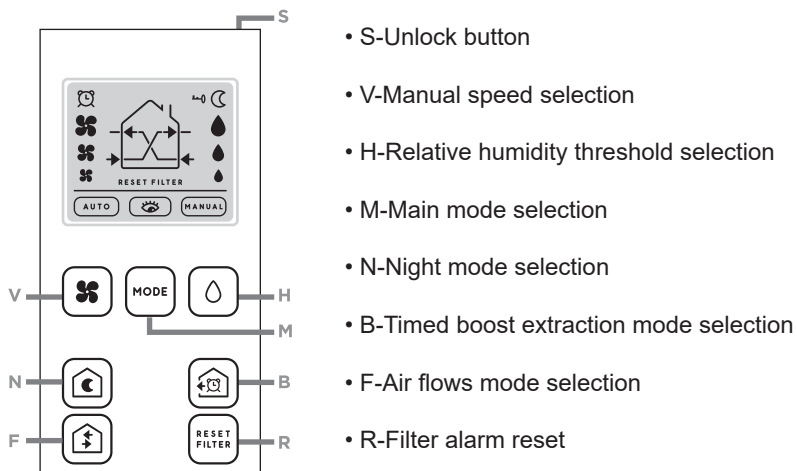

INSTRUCTIONS FOR USE

To select any function press the related button.

To unlock the buttons press the button (S) placed in the upper part of the remote control.

For detailed explanation of all the operating modes refer to the manual:
Installation Operation Maintenance

WALL MOUNTED HOLDER FOR REMOTE CONTROL

Fix the remote control holder to the wall as shown in the picture below.

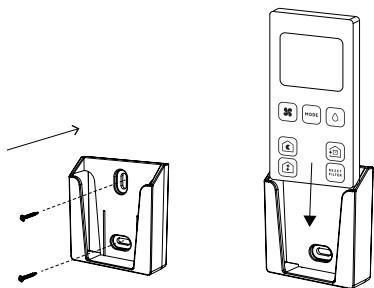



160RE

www.ahlsell-vvs.dk
info@ahlsell-vvs.dk

0045 3819 0000

UNOKLIMA

XT160

www.vvs-trading.dk
salg@vvs-trading.dk

0045 7342 4300